

# Installation Guide

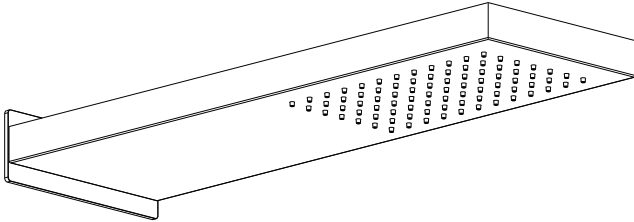

# Shower Head Installation Instructions

---

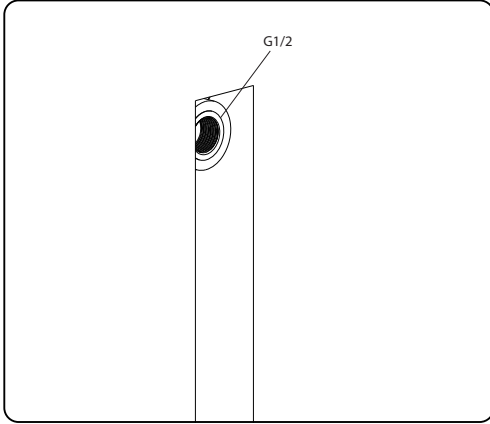

**Please flush the pipe first to avoid the debris go inside the head shower.**

**The pipes need to have G1/2 internal thread interfaces reserved.**

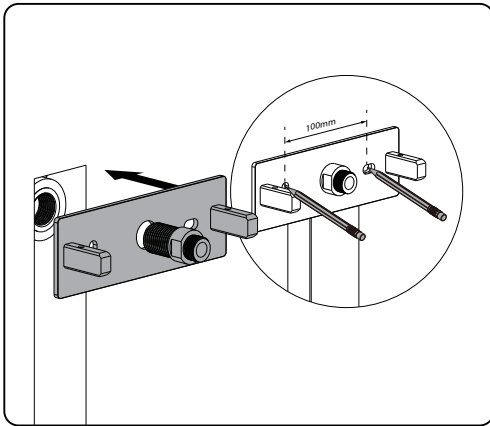

Use the mounting base and adapter as a template, use a pencil to mark the locations on the two mounting holes where drilling is needed. The center distance between these two marks is 100mm.

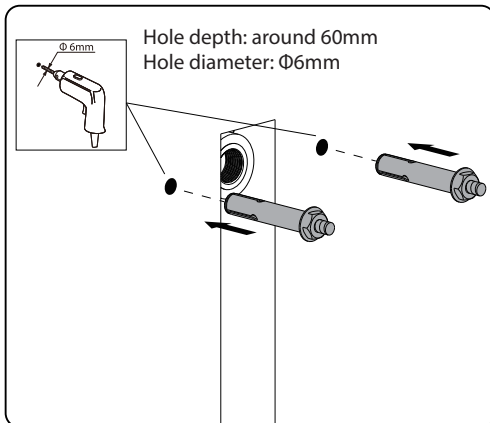

Drill holes at the marked positions with a diameter of  $\Phi 6\text{mm}$  and a depth of 60mm. Insert the metal anchor into the holes.

# Shower Head Installation Instructions

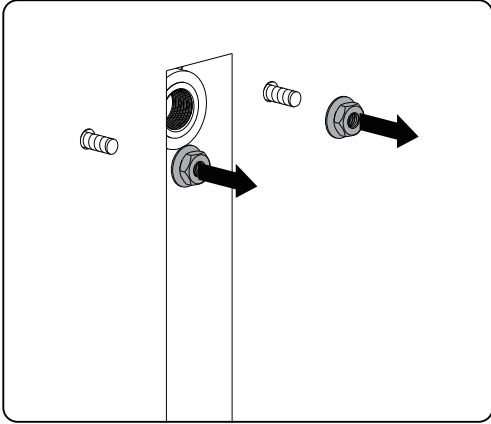

Remove the nuts and metal washers from the metal anchor and set them aside for later use.

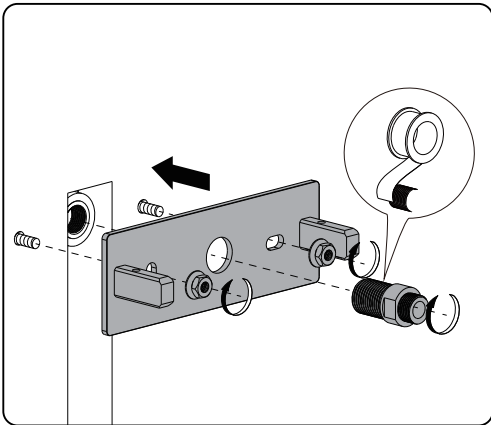

Use the removed nut and washer to install the mounting base onto the wall and tighten it. Wrap the G1/2 to G3/8 adapter's G1/2 end with Teflon tape, and use a wrench to screw it into the wall pipe. **(be sure to check for leaks).**

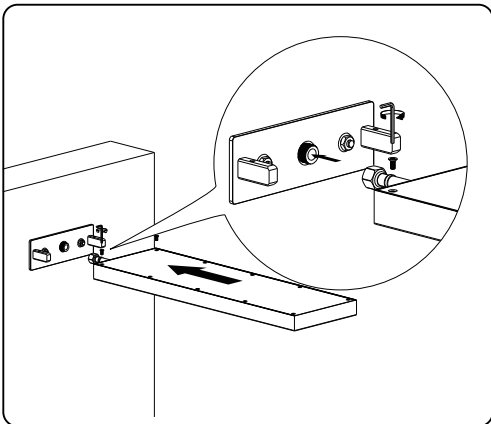

Connect the shower head hose to the G3/8 port of the adapter, then install the shower head onto the mounting base and tighten it with the included hex wrench.

## Dimension

---

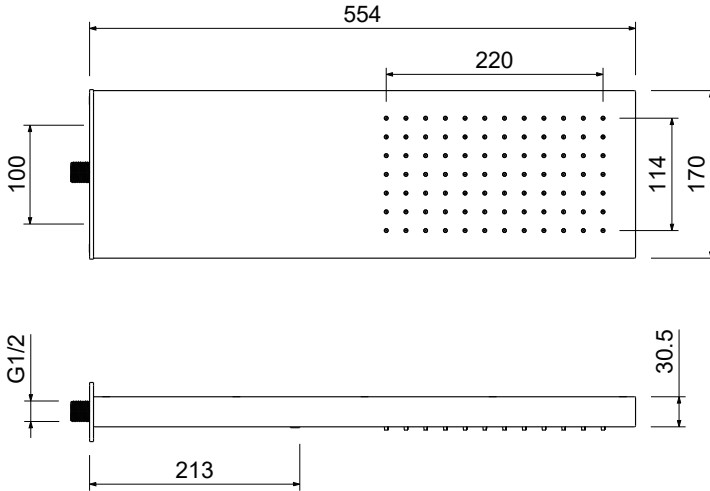

## Cleaning and care

---

Our Kitchen and bathroom products are made of the best materials to comply with the needs of the market with regard to design and functionality. To avoid damage to the product, it is necessary to take proper care of it.

Clean the products often with a soft cloth to keep it looking like new. For heavy cleaning you can use mild liquid detergents or non-abrasive liquid polisher. Rinse with water and dry with a soft cloth. Avoid abrasive cleaners, steel wool and harsh chemicals as these will dull the finish and void your warranty.